

# LONA



**2017 ANNUAL  
REPORT**

## **Mission**

Iona supports people as they experience the challenges and opportunities of aging. We educate, advocate, and provide community-based programs and services to help people age well and live well.

## **Vision**

We envision a community that celebrates, values, respects, and protects the contributions and possibilities of every individual.

# ONWARD

Front cover: Wellness & Arts Center participant Marina Quijano dances with staff member Cecilia Sono.

**AT IONA** we frequently talk about “the challenges and the opportunities of aging.”

The past year presented a lot of challenges.

Locally, the affordable housing crisis is having a significant impact on older adults. Rents in the District are rising faster than Social Security or disability benefits. The rising cost of groceries and prescriptions, plus the increase in traffic, present life-threatening challenges for older adults. Nationally, efforts to dismantle the Affordable Care Act, threats to Meals on Wheels, and changes to the tax code that put Medicare and Medicaid at risk are serious cause for concern.

Yet, 2017 also had its share of opportunities—in no small part thanks to your support.

While a member of Congress disparaged the White House as an “adult day care center,” your financial support allowed us to expand our award-winning adult day health program, Iona’s Wellness & Arts Center, to accommodate more people. While a national debate raged over home-delivered food programs, you volunteered to deliver nutritious meals to isolated seniors—week after week. While federal budget cuts targeted the arts, you showed up to celebrate the artistic contributions of older adults in our Lois & Richard England Gallery and at the Phillips Collection. And while LGBTQ protections were under attack, Iona welcomed LGBTQ Baby Boomers to a customized Take Charge/Age Well Academy™ series to help them plan the next stage of life.

The current political climate has not and will not deter us from our mission. If anything, 2017 was a reminder of the relevance and importance of our work. In the words of one donor: “While there was a tremendous amount of uncertainty in 2017, one thing remained certain: our community is better off because of Iona.” Kind words along with your financial donations and volunteer hours helped us to remain focused on and committed to the opportunities before us. For that, we are truly grateful.

Onward.

Elizabeth B. O’Hara, *Board President*  
Sally S. White, *Executive Director*



I do  
this  
work  
with  
all my  
heart.



**MARINA QUIJANO** is independent and headstrong. She is also humble and generous.

Marina left her native Colombia in 1949 in the midst of that country's bloody civil war to join her parents in Washington, DC. "In Colombia, she was never expected to work," says her brother Peter, a New York-based attorney. She was expected to get married and raise a family.

But Marina had an independent streak. Instead of a more traditional role, she landed a job in the District with a local real estate company. She threw herself into her career and rose to a management position. She never married or had children. Her colleagues became a second family. In 2011, she retired at age 84.

Now 90, Marina still goes to "work." But instead of going to an office, she goes to Iona's Wellness & Arts Center, an adult day program for older adults with dementia, Parkinson's Disease, and other chronic conditions.

"She's worked for 60 years," says Peter. "It's what she knows how to do. Iona provides something no one else can: a safe and supportive place where Marina has a sense of self-worth. That's something all of us want—no matter how old we are." In addition, Peter says, it gives him peace of mind to know she is in a safe, supportive environment.



In 2017, we served

**233**

participants and families in the Wellness & Arts Center.



At Iona, Marina dresses the same way she did when she went to the office, always with a purse to complete the outfit.

“I’ve seen a real change in my sister since she started at Iona,” says Peter. “Once again, she has a purpose. I noticed it almost immediately after she...I was about to say ‘started working there.’”

“Marina likes to feel needed,” adds Sharon O’Connor, director of the Wellness & Arts Center. “She is happiest when she is doing something helpful. So we put her to ‘work.’” Marina helps “lead” exercise classes and clears the tables after lunch. In addition, since Marina was trained in Colombia as a classical singer, the staff frequently invites her to share a song. She recently performed the national anthem at Iona’s Celebration of Achievement, an annual Wellness & Arts Center program that recognizes participants’ accomplishments.

“We talk about a strength-based program,” says Sharon. “What that means is we figure out what makes people tick, what brings them joy. We figured out right away what brings Marina joy: helping people.”

“Every time I step foot in this place it’s like stepping foot in heaven. I do this work with all my heart,” says Marina.



*“Without Iona,  
I wouldn’t have  
known about  
St. Mary’s Court—  
or how to apply.”*

## GREGORY SHADLEY

had an eclectic career—first in the medical field, then at Tower Records, where he combined work with his passion for music, and finally as the sacristan at Georgetown University, responsible for the altar, vessels, and vestments used by the priests.

It’s at Georgetown where he started having health issues. It’s a long, scary list that includes diabetes, a pulmonary embolism, and, more recently, multiple strokes. He’s 62.

Gregory’s been fortunate to have had stable housing for 12 years. But, his basement apartment can only be accessed by eight steps. In order to get his groceries down the steps, Gregory has to move the bags slowly, one at a time, so he doesn’t lose his balance. In the past year, he’s had five falls that resulted in head trauma.



Clearly, living in an inaccessible basement apartment is not ideal.

Gregory receives government disability benefits. But after paying rent and basic necessities, there is little left over. “When I was younger, I never imagined I’d go on disability. I never imagined I’d retire early because of my health. I was completely blindsided.”

However, when he counts his blessings, he starts with Iona.

Feeling overwhelmed by his health, housing, and financial challenges, Gregory reached out to Iona. Right away, Iona assigned a case manager to help Gregory navigate the complex world of local and federal benefits—many of which he didn’t know he could get.

# Iona is the friend that’s always



## 538

vulnerable older adults in the community benefited from our expert case management and counseling support.



With Iona's assistance, Gregory applied for food stamps, a reduced Metro fare card, a rental rebate, a home health aide, a DC identification card, and a free "Safelink" phone. (When he had previously fallen, there was no way to call for help because he couldn't afford a phone.)

In addition, his case manager told him about the subsidized apartments for seniors at St. Mary's Court in Foggy Bottom and helped him fill out an application. The waiting list is long, but he's willing to wait for an accessible apartment. Gregory feels it's the best option. It will bring his rent down considerably and he won't have to navigate any steps to get to his apartment.

"Without Iona, I wouldn't have known about St. Mary's Court—or how to apply," he says. "Iona is the friend that's always there."

With your support, our dedicated social workers and nurses protect older adults from exploitation, arrange home-delivered meals, and put in place critical, and often lifesaving, care plans at home.

# there.

# Care for caregivers

*“What I do for my husband is not impossible. But, it’s hard and slow. But thanks to Iona, I don’t have to worry so much anymore.”* —LINDA HEANEY

**3,934**

calls to our free Helpline, many from family caregivers looking for answers and compassion.

**562**

family caregivers found solutions, respite, and solace through Iona’s direct services.

**8**

support groups gave family members emotional comfort and practical advice.







I should have learned to cook.

Back in 1976, when **WILLIAM REID** and his mother bought a three-bedroom house in the District's leafy Chevy Chase neighborhood, he imagined living there with his future wife and children—maybe even a son who would carry on the family name. But that was not to be.

Instead, 41 years later, William lives alone. After a long career as a regional economist at the U.S. Department of Commerce, he took early retirement because of health challenges. His mom, who for many years cooked his favorite dishes—like pork and beans, sautéed liver, and homemade cakes and pies—passed away 20 years ago.

His debilitating psoriatic arthritis (the same thing professional golfer Phil Mickelson has) makes shopping and cooking difficult, if not impossible. He's had both knees and both hips replaced and lived with club feet since birth.



Having given up driving a year ago, William's world is shrinking. On a good day, the 74-year-old moves from his living room to the adjacent porch to use his computer, which serves as a lifeline to the outside world. He rarely leaves the house.

"I should have learned to cook," he admits. "But I was an only child and my mother spoiled me." Immediately after her death, William resorted to eating breakfast at McDonalds, going to the local food court, and ordering take-out Chinese food or pizza. He taught himself to use the microwave to heat up frozen meals. As a result, he gained weight, developed diabetes, and blood clots. That was a low point.

The high point was learning he was eligible to receive home-delivered meals through Iona. In partnership with the DC Office on Aging, Iona arranges for the delivery of 10 nutritious meals to his door every other Friday. (William supplements that with food delivered by a local grocery store.)

Older adults are particularly vulnerable to the effects of poor nutrition, hunger, and food insecurity. Last year, 220 older adults received 47,292 meals through Iona. Like William, many of the recipients live alone.

"The meals are healthy, there's good variety and, most importantly, they taste good," William says. His favorites include the apple-walnut oatmeal breakfast and the home-style meatloaf dinner. In addition, every Saturday an Iona volunteer delivers a hot meal ready to eat and a cold meal for later in the weekend. "Sometimes parents bring their children to the door: he says. "It's wonderful to see a cheerful face on a Saturday morning! I don't think they have ever missed a Saturday."

**47,292**  
meals were  
delivered in 2017.



*"The meals are healthy, there's good variety and, most importantly, they taste good."*



**ZELDA KAPNER, 85**, never found her soul mate, but she did find Iona. As a regular participant in Iona's Active Wellness Program at St. Alban's, she has made friends; gets a daily dose of exercise, current events or culture; and enjoys a midday meal.

She's not alone. Each weekday, 35 or more men and women gather for conversation, an activity, and a meal. Her lunch table is a mix of new and returning participants. There's Sarah, who's been coming for five months. Recently "retired," she works two days a week for a former ambassador. Alec is a retired psychotherapist. And Sherry, who has been coming for nine years, is an artist. "I belong to a gym," she says, "but—in contrast to Iona's program—I find it lonely going there because I don't know anyone. Iona is an entirely different experience."

Zelda agrees. A native of New York, she came to the District in 1973 to work at a national women's organization. She found a rent-controlled apartment in Foggy Bottom, where she's been ever since. "I know a good thing when I see it," Zelda says.

She could just as easily be referring to Iona.

When Zelda retired at age 67, she recalls the words of a dear friend: "Make sure you have something to do every day."

## Iona has your back.



At Iona's Active Wellness Program, "you meet the most interesting people who have the most interesting lives," says Zelda. "Iona broadens your universe." Beyond the participants are the many high school students who volunteer their time, young people who "give you faith in the future," says Zelda.

While Iona enlivens Zelda's social life, "it also has my back," she says. Zelda has instructed her niece—who is executor of her will—that the first call she should make in the event of a crisis is to Iona.

"I had a friend living in a group house where the landlady was taking advantage of her," recalls Zelda. "I referred her to an Iona social worker who helped her find new housing. Iona saved her life."



Of her own experience, Zelda says: "If I wake up and think, 'another boring breakfast,' all I have to do is head to Iona, which makes me smile." Zelda and other participants credit program manager Courtney Tolbert, who, in Zelda's words, is not only a creative and effective leader "but has a big heart."



*“If I wake up and think, ‘another boring breakfast,’ all I have to do is head to Iona, which makes me smile.”*

---

**119**

men and women from diverse backgrounds attended the Active Wellness Program in 2017.

**6,693**

nutritious mid-day meals were served while friendships blossomed.

They enjoyed topical discussions, films, field trips, and fitness.

Thanks to you, in 2017  
Iona directly helped

**2,958**

older adults and their  
families with the challenges  
and opportunities of aging.

#### **OUR DONORS**

*2017 Contributors (FY October 1, 2016 – September 30, 2017)*

Every gift supports Iona's mission to help people age well and live well. We appreciate all of the donors who contributed in fiscal year 2017. Thank you! We strive for accuracy. If your information is incorrect or if you prefer to be listed differently in the future, please contact us at (202) 895-9416 or [development@iona.org](mailto:development@iona.org).

# 2017 DONORS

## \$100,000 & UP

Anonymous  
Morris and Gwendolyn Cafritz Foundation  
The Estate of Mr. Jerry Knoll  
Mrs. Marjorie Rachlin

## \$50,000-\$99,999

Agua Fund, Inc.  
The Lois and Richard England Family Foundation  
Philip L. Graham Fund  
Greater Washington Community Foundation

## \$25,000-\$49,999

William S. Abell Foundation, Inc.  
Bainum Family Foundation  
Capital City Nurses Cottage at Curry Manor  
Clark Winchcole Foundation  
Consumer Health Foundation  
The Estate of Ann H. von Luttichau  
United Way of the National Capital Area

## \$10,000-\$24,999

Aid Association for the Blind  
Mr. & Mrs. Samuel A. Alward  
Anonymous  
A. James and Alice B. Clark Foundation  
City Fund of the Community Foundation  
DC Commission on the Arts and Humanities  
Mrs. Louisa C. Duemling  
Mrs. Elaine Melmed  
Fund for Education & Human Services  
Ms. Jessie M. Harris & Mr. Woody Cunningham  
Legal Counsel for the Elderly  
Roadside Development  
Polly Shackleton Fund for Iona Senior Services  
Share Fund of the Community Foundation  
Ms. Sharon L. Smith  
Mr. & Mrs. Richard W. Snowdon, III  
Mr. Armond Spikell & Ms. Lisa Spikell  
Venable Foundation

## \$5,000-\$9,999

Alzheimer's Foundation of America  
Anonymous  
Mr. George Arnstein  
Arbor Place Dementia Care  
Dr. Walter H. Fanburg  
Ms. Jennifer C. Berrent & Ms. Carolyn E. Taylor  
Ms. Keith L. Carr & Mr. George H. Bohlinger, III  
Dr. E. Eugene Carter & Dr. Rita Rodriguez  
The Max and Victoria Dreyfus Foundation, Inc.  
Evergreen II Trust  
Frank M. Ewing Foundation, Inc.  
Forest Hills of DC  
Forest Side Memory Care  
Mr. & Mrs. John A. Goodman  
Green Charitable Foundation  
Corina Higginson Trust  
The Estate of Mary E. Hileman  
Home Care Assistance  
Jovid Foundation  
Mr. & Mrs. Edward H. Kaplan  
The Estate of Barbara H. Kemp

KPMG  
Mrs. Nevin Kuhl  
Mr. & Mrs. Richard S. Lake  
Mary and Daniel Loughran Foundation, Inc.  
Mars Foundation  
Marshfield Associates  
Mrs. Mary Lou McGee & Mr. Robert McGee  
Helen Wardman Naselli Memorial Fund  
The Residences at Thomas Circle  
Mrs. Ann M. Schweitzer & Mr. Mark A. Schweitzer  
George Wasserman Family Foundation  
WC Smith

## \$2,500-\$4,999

Ms. Emily S. Allen  
AlfredHouse Eldercare, Inc  
Anonymous  
AARP-DC  
Care For You, Inc.  
CareFirst BlueCross BlueShield  
Complete Care Solutions LLC  
Dimick Foundation  
Ms. Adrienne Dominguez  
Eden Homes Group  
Mr. & Mrs. Richard England, Jr.  
Mr. R. Peter Fitzgerald & Mr. James Whittaker  
Five Star Premier Residences of Chevy Chase  
Gelman, Rosenberg & Freedman  
Georgetown Home Care  
Grand Oaks  
Hogan Lovells LLP  
Kensington Park Senior Living  
Mr. Sam Kilpatrick & Mr. Doug Barker  
LifeMatters  
Mr. & Mrs. Daniel K. Mayers  
Ms. Mary Frances McGuinness & Mr. John McGuinness  
Mr. Joe L. Oppenheimer & Ms. Edith A. Fraser  
Options for Senior America  
Psychiatric Institute of Washington  
Ms. Maxine M. Rapoport  
Harold and Irma Rubenstein Family Foundation  
Ms. Elinor H. Stillman  
Mr. Michael Tanner & Mrs. Eileen Tanner  
Mr. Edward Timberlake & Mrs. Mary Gael Timberlake  
Wells Fargo Advisors  
Ms. Sally S. White & Mr. Robert E. Drucker  
Ms. Debra D. Yogodzinski

## \$1,000-\$2,499

ANC 3 B  
Anonymous  
Ms. Nanci E. Banks & Mr. Steven Monteiro  
Mrs. Caroline Dixon Bartman  
Dr. Rhoda Baruch  
Ms. Ina Bechhoefer  
Ms. Wendy Feldman Block & Mr. Eben Block  
Ms. Virginia Boothe  
Mrs. Amelie Burgunder & Mr. B.B. Burgunder, Jr.  
Mr. & Mrs. Roy E. Cashion  
Mr. Derrick Chin  
Christ Church, Georgetown  
Mr. John Collinge

Ms. Pamela C. Cooper & Mr. David M. Cooper  
Mr. & Mrs. John M. Derrick, Jr.  
Ms. Jennifer Disharoon  
DNE and Associates and Ms. Daphne Edwin  
Dr. Margery Elfin  
Elno Family Foundation  
Ms. Elizabeth J. Elson  
Mr. & Mrs. Preston A. Englert, Jr.  
Ms. Elizabeth S. Fox & Mr. Tom H. Fox  
George Washington Cancer Institute  
Mr. Robert T. Gerken & Mrs. Thelma Gerken  
Giant Food LLC  
Mr. Chad Goldberg  
Mr. Jeff Gordon & Ms. Beth McGarry  
Mrs. Nancy Gould  
Mr. & Mrs. William H. Greer, Jr.  
Mr. Neal R. Gross & Mrs. Ava Gross  
Ms. Ruth G. Hofmeister  
S. Kann Sons Company Foundation, Inc.  
Mrs. Carol Kaplun & Mr. Paul T. Kaplun  
Ms. Helene G. Kenny  
Mr. Raymond B. Kummer & Mrs. Frances Z. Kummer  
Mr. Scott Lanham  
Dr. Benjamin Lee & Mrs. Eileen Lee  
Mr. Terry Lenzner & Mrs. Margaret Lenzner  
Mrs. Susan V. Linsky & Mr. Norman Linsky  
Ada Harris Maley Memorial Fund  
Mr. Paul D. Manca & Mrs. Lori A. Manca  
Ms. Judith F. Mazo & Mr. Michael Seidman  
Ms. Shawn P. McLeod  
Ms. Elizabeth Merricks & Mr. Edward Reardon  
Ms. Susan Messina & Ms. Maryann Krayer  
Ms. Laree Martin  
Mrs. Maria Teresa Meyer  
Mr. Barry W. Nishikawa  
Dr. Mark Novitch & Mrs. Louise Novitch  
Mr. Lawrence C. Nusssdorf & Mrs. Melanie Nusssdorf  
Ms. Elizabeth B. O'Hara & Mr. Theodore Lazo  
Posner Wallace Foundation  
James and Theodore Pedas Family Foundation  
Mr. Bennie N. Reynolds  
Ms. Sarah Harbison Robinson  
Rogers & Company PLLC  
Ms. Rita W. Ross & Mr. Charles Ross  
Rotary Foundation of Washington, D.C.  
Ms. Shannon M. Russell  
Mr. David A. Santos  
Ms. Susan Sayre  
Mr. Richard Seaton & Mr. John Berger  
The Honorable Jeffrey Z. Slavin  
St. John's Church, Lafayette Square  
Mr. Charles W. Stellar  
Ms. Laura E. Stone & Mr. Ezra Levine  
Dr. Emil M. Sunley  
Mr. J. Chapman Todd & Ms. Willa D. Morris  
Mr. Robert Toderò & Ms. Cherish Medawar  
Ms. Rajyashree Tripathi Chiramal  
Mr. & Mrs. Mallory Walker  
Washington Gas  
Washington Hebrew Congregation

Ms. Barbara O. Wege & Mr. Stephen R. Wege  
Mrs. Elizabeth S. White  
Mr. & Mrs. Kenneth R. Woodcock  
Ms. Marjorie Zaprunder  
Ms. Dorothy Zolandz

## \$500-\$999

Ms. Sonya Ali  
Mr. Illa Amerson  
ANC 3 F  
Anonymous (2)  
Dr. Bascom F. Anthony & Dr. Marietta M. Anthony  
Mr. Richard Armstrong & Mrs. Sharon Armstrong  
Mrs. Nina Austin & Mr. Chris Austin  
Mr. David Booth Beers & Ms. Margaret G. Beers  
Ms. Gloria E. Blazsik  
Mr. Abram Boni & Ms. Anne Boni  
Mr. Trevor Boothe  
Mr. Derick W. Brinkerhoff  
Ms. Norma Brooks  
Mr. James P. Landry & Ms. Nicole Burton  
Capital Memorial Church of Seventh Day Adventists  
Dr. Kirsten Chadwick & Mr. Marc Zwillinger  
Mrs. Sandra Christenberry  
Church of the Pilgrims  
Mrs. Rose Clifford & Mr. Tim Clifford  
Ms. Judy Cranford & Mr. David Kline  
Ms. Diane Dragaud  
Ms. Coleen Drucker  
Ms. Fiona Druy  
Ms. Linda Dubroof  
Ms. Jean Emery  
Ms. Marietta Ethier  
Ms. F. Joyce Fernandez  
Mr. James Flug & Ms. Carla C. Flug  
Mrs. Frances E. Forman  
Mr. Arthur Frank  
Ms. Elisabeth R. French  
Mr. Matthew A. Frumin & Ms. Lena S. Frumin  
H&R Block  
Ms. Margaret F. Hennessey  
Ms. Andrea K. Herrick  
Mrs. Helen M. Huling  
Just in Time Church  
Mr. & Mrs. Joseph T. Kelliher  
Mrs. Helen Kenney & Mr. David Kenney  
Ms. Marie Kissick  
Ms. Marilyn W. Klein  
Ms. Elizabeth H. Kraft  
Mrs. Catherine Laxton & Mr. William Laxton  
Mr. & Mrs. Irwin Lebow  
Ms. Elisabeth K. Lescault  
Mrs. Lee Lockwood & Mr. Peter V. Lockwood  
Dr. Clara M. Lovett  
Ms. Michele M. McNally  
Ms. Sheila Meehan  
Ms. Carolyn Miller  
Mr. Frank Monahan & Mrs. Norma Monahan  
Ms. Hazel C. Moore  
Ms. Melissa Daniel Morris  
Mrs. Louise C. Myers & Mr. Matthew L. Myers



**Pictured from left to right: Deputy Mayor HyeSook Chung, Mayor Muriel Bowser, Executive Director Sally S. White, and DC Office on Aging Director Laura Newland.**

Iona celebrated 20 years in the Isabella Breckinridge Center on Albemarle Street NW, in Tenleytown. In recognition of this anniversary, Mayor Muriel Bowser presented Iona with a declaration honoring our excellent services in the community. She thanked us for being advocates for District residents, and expressed her support of our goal to bring adult day services to Wards 7 and 8 in the future.

National United Methodist Church  
 Ms. Darwina L. Neal  
 Mrs. Virginia Newmyer  
 Mrs. Marthe M. Norbury  
 Our Lady of Victory Catholic Church  
 Mr. T. S. L. Perlman  
 Mr. Creighton Phelps  
 Ms. Sarah Pokempner  
 Ms. Ana M. Raley  
 Mr. Yosef Riemer & Ms. Vitina Biondo  
 Ms. Anne L. Roger & Mr. Robert T. Haas  
 Ms. Kay E. Rogers  
 Mrs. Cynthia Cox Roman &  
 Mr. Peter Roman

Mr. & Mrs. Walter S. Sechrist, III  
 Mr. & Mrs. Alexander Shakov  
 Ms. Kathleen K. Smith  
 Ms. Leslie C. Smith &  
 Mr. Joseph C. Goulden  
 Mr. Robert Stillman &  
 Ms. Margaret C. Stillman  
 Ms. Alice Tetelman  
 The U.S. Charitable Gift Trust  
 United Way of Central Maryland  
 Ms. Bernice Weinstein  
 Ms. Catherine L. Williams &  
 Mr. David Popp  
 Ms. Robin Wink  
 Mrs. Evelyn M. Wrin & Mr. Robert L. Wrin

**\$100-\$499**  
 Ms. Patricia E. Abell  
 Ms. Eleanor Acheson &  
 Ms. Emily Clark Hewitt  
 Ms. Pearl Acquah  
 Mr. Thomas M. Adams &  
 Mrs. Margaret O. Adams  
 Ms. Olivia Adler  
 All Souls Memorial Episcopal Church  
 Ms. Margaret Almazan  
 Ms. Carolyn S. Alper  
 Ms. Debra Alvarez  
 Mr. William Amt  
 Ms. Eileen Andary  
 Mr. Paul Anderson  
 Mr. Avyeris Andonyadis &  
 Mrs. Elly Andonyadis  
 Anonymous (9)  
 Ms. Rosalyn Aquila  
 Ms. Donna Ari  
 Mr. Geoffrey F. Aronow &  
 Ms. Melinda J. Halpert  
 Mr. Jorge Asef Sargent  
 Mr. David Austin  
 Mr. Jon Austin  
 Ms. Suzanne Badoux  
 Mr. Clark P. Baker  
 Dr. Violet E. S. Baker  
 Mr. P. Terry Balazs  
 Mr. Clark Ball  
 Ms. Elizabeth Ballard  
 Ms. Kathy Balog  
 Mr. Edwin L. Barber & Ms. Alison Martin  
 Ms. Jacquelyn Barker  
 Mrs. Paula B. Barrie  
 Mrs. Mary T. Bartlett  
 Mrs. June Bashkin  
 Ms. Ruthann Bates &  
 Dr. Richard D. Bates, Jr.  
 Ms. Marcia Bauman  
 Ms. Maria Mercedes Bejarano  
 Bench Trail Fund  
 Mrs. Margaret R. Bennett  
 Mr. & Mrs. John W. Benoit  
 Ms. Gale Bentley  
 Ms. Jane Berger  
 Mr. Rahsaan Bernard  
 Mrs. Edgard F. Bertaut  
 Ms. Juliette Bethea  
 Mr. Blake Biles & Dr. Laura Sessums  
 Ms. Mary M. Bird  
 Mrs. Nathalie V. Black  
 Dr. Amy S. Bloom  
 Ms. Ana Maria Boitel  
 Mr. Rick Miller & Ms. Amy Borrus  
 Ms. Alba Boyer  
 Mr. Kevin Bradley  
 Mr. & Mrs. Ralph F. Braun  
 Mr. & Mrs. Robert P. Bremner  
 Ms. Bethany J. Bridgham  
 Mr. James E. Britt & Mrs. Martha D. Britt  
 Ms. Arlene A. Brown  
 Mr. Frederick Z. Brown &  
 Ms. Ellen Herscher  
 Dr. Peter Brusoe  
 Mrs. Gloria B. Buckberg  
 Mr. Irwin S. Buncher &  
 Mrs. Judith F. Buncher  
 Ms. Betsy C. Burman  
 Ms. Susan B. Burnett  
 Mr. Warren E. Burton  
 Mr. Michael F. Butler  
 Ms. Sandra Byrne  
 Ms. Bonnie J. Cain  
 Ms. Asimina Caminis  
 Ms. Holly Cannon  
 Mr. Lincoln W. Caplan & Ms. Susan Carney

Ms. Sue Carlton  
 Ms. Wendy Carnival  
 Mrs. Barbara Carpenter  
 Ms. Ann Carper  
 Mr. Francis S. Carr  
 Mr. C. Wesley Carson &  
 Mrs. Carol S. Carson  
 Mr. Lennie Carter  
 Mr. Luther Carter &  
 Mrs. Marsha Knott Carter  
 Ms. Elizabeth R. Carty & Mr. Ernest Galvan  
 Mr. Gregory J. Case &  
 Mrs. Lisa Pericola Case  
 Ms. Tanja H. Castro  
 Catalogue For Philanthropy  
 Mr. George Chaconas &  
 Mrs. Donna Chaconas  
 Mr. Joe Chalmers  
 Ms. Louise C. Chambers  
 Mr. & Mrs. Brian J. Chappelle  
 Ms. Patricia Chick  
 Mr. James R. Child &  
 Mrs. Margaret S. Child  
 Ms. Lindsay Childress Beatty  
 Mrs. Hope K. Childs  
 Mrs. Nancy Chistolini  
 Ms. Margaret Chou Bowman  
 Dr. Thomas Chused  
 Ms. Jane Cicala  
 Mrs. Judith L. Clark  
 Ms. Barbara Cline  
 Mr. Adam F. Clymer  
 Mr. Philip Green & Dr. Elizabeth L. Cobbs  
 Mr. John Coffey  
 Mr. Bruce A. Cohen  
 Mr. Sig Cohen & Mrs. Susan Cohen  
 Ms. Jo Collinge  
 Mrs. Mary A. Cooper  
 Ms. Jacqueline Corbett  
 Ms. Victoria R. Cordova  
 Dr. & Mrs. Ronald M. Costell  
 Mr. Edward Cowan &  
 Mrs. Ann Louise W. Cowan  
 Ms. Elaine Crockett  
 Mrs. Roberta C. Cronin &  
 Mr. Philip F. Cronin  
 Mr. Andrew Cruikshank &  
 Ms. Catherine St. Denis  
 Mr. Jorge L. Cuadros Riera  
 Mr. Joseph M. D'Amico  
 Mr. William D'Antonio &  
 Mrs. Lorraine D'Antonio  
 Ms. Matilda S. Davis  
 Davis Research LLC  
 Mrs. Rosa Dean  
 Mr. & Mrs. William Delaney  
 Ms. Carol Delany  
 Ms. Drusilla Demmy &  
 Mr. Henry E. Bowden  
 Ms. Yiu Fong Dew  
 Mr. Reed T. Dewey &  
 Ms. Betsy Reinstein Dewey  
 Ms. Rosalyn P. Doggett  
 Mr. Edward J. Doheny  
 Mr. Robert B. Dollison  
 Mr. Cletus Durkin  
 Mr. Seymour H. Dussman  
 Mrs. Nancy P. Dutro  
 Mrs. Frances M. Duttikin  
 Mr. Daniel B. Edelman &  
 Mrs. Toby Edelman  
 Ms. Anne Eigeman  
 Ms. Diana M. Elkin  
 Ms. Farar Elliott  
 Ms. Gretchen Ellsworth  
 Ms. Kelley Ellsworth  
 Mr. George T. Esherick



Mr. Robert Evans  
Mrs. Elaine C. Everly  
Ms. Regina Ewig  
Mr. John Fegen  
Mr. & Mrs. Myron Feinsilber  
Mr. & Mrs. David E. Feldman  
Ms. Phoebe A. Felk  
Ms. Adrienne Fields  
Dr. Barbara Finkelstein  
Ms. Wendy Finn  
Ms. Valerie Florez  
Ms. Mary Ann Floto  
Ms. Angelyn S. Flowers  
Ms. Heather Foote  
Ms. D. Forrest  
Ms. Priscilla Fothergill  
Ms. Cynthia Fowle  
Mr. Jim Fox  
Mr. Stuart Horn & Ms. Marian R. Fox  
Mrs. Helen L. Francke  
Ms. Barbara B. Franklin  
Mrs. Lucile C. Freeman  
Mr. Mark H. Freeman &  
Mrs. Frances S. Freeman  
Mrs. Katherine Freshley &  
Mr. Jerry Freshley  
Ms. Elizabeth J. Frick  
Ms. Lara Friedman  
Ms. Katherine Ann Gardner  
Ms. Pilar Garffer  
Dr. Wendy Gasch  
GE Foundation  
Mr. & Mrs. Edward Geier  
Ms. Suzanne Gentes  
Ms. Amy C. Gilbert  
Ms. Mary J. Glass  
Mr. Todd Glassman  
Mr. Daniel L. Glick & Mrs. Gail M. Glick  
Ms. Pat Goeldner  
Mr. Daniel T. Goggin  
Ms. Debbie J. Goldman  
Ms. Judith E. Goldstein  
Mr. Richard Gow  
Ms. Sandra Grant  
Mr. George D. Greenberg  
Ms. Diane Greenspun  
Mrs. Malvolia Gregory  
Ms. MaryAnn Griffin  
Mr. Robert P. Groberg &  
Mrs. Deborah Groberg  
Ms. Sarah Grogan  
Ms. Mary Gronlund  
Mr. Edward Grossman &  
Mrs. Shelley Grossman  
Mr. Max Grunstein &  
Mrs. Helen Grunstein  
Mr. Kay D. Guiles  
Ms. Dorothy J. Gusler  
Mr. Joseph H. Guttentag &  
Mrs. Merna C. Guttentag  
Mrs. Betty Guyot & Mr. Henry L. Guyot  
Mrs. Nicole A. Halbreiner  
The Reverend Canon Michael P. Hamilton  
Ms. Jane Hardin  
Mr. Christie Harris  
Mr. Sherman Harris  
Mrs. Jean Harrison & Mr. Earl Harrison

Ms. Linda Jean Kimball Harsh  
Ms. Alexandra T. Hart  
Mr. Thomas L. Hartman &  
Mrs. Bridget D. Hartman  
Mr. Alexander Haslam  
Mr. Michael F. Healy  
Mr. Harry Hedges & Mrs. Kamla Hedges  
Mr. & Ms. Martin Heyert  
Ms. Molly Heylin & Mr. Brock Heylin  
Mr. Elliott M. Himelfarb & Ms. Janet R. Minker  
Mrs. Michele Hird & Mr. David Hird  
Ms. Lucy T. Hodas & Mr. Frank Hodas  
Ms. Sandra M. Hoexter  
Ms. Lee M. Hoffman  
Mr. Ernest Hoosman  
Mr. Roland Hoover &  
Mrs. Cynthia A. Hoover  
Mr. Richard C. Hotvedt &  
Mrs. Catherine S. Hotvedt  
Ms. Sherry M. Houghton  
Mr. & Mrs. Lewis J. Hubbard  
Mr. Cecil Hunt  
Mrs. Ann L. Ingram  
Ms. Ruth C. Innes  
Ms. Rochelle H. Jaffe  
Mr. & Mrs. Joseph H. Jarboe  
Ms. Linda Jewell  
Mrs. Nancy M. Johns  
Ms. Lorna E. Johnson  
Ms. Martha F. Johnson  
Ms. Nancy E. Johnson  
Ms. Blair Jones  
Mrs. Jane A. Josephs  
K and K Life Partners Fund  
Mr. Cary Kadlecek  
Mr. Michael A. Kosecoff &  
Mrs. Caren J. Kamberg  
Ms. Amy Kandel  
Ms. Jessie M. Kane  
Jerome A. Kaplan & Deena L. Kaplan  
Family Foundation  
Ms. Sally Kaplan & Ms. Julie Kaplan  
Ms. Sherry Kaskey  
Ms. Ann E. Keeler & Mr. Matthew C. Dinkel  
Mr. William J. Keery  
Ms. Sarah Ely Kelly  
Mr. & Mrs. John E. Kern  
Mr. Joseph Kerr & Mrs. Andrea Kerr  
Mr. Freddy A. Khoury &  
Mrs. Laila T. Khoury  
Ms. Jacqueline M. Kienzle  
Ms. Soye Kim  
Ms. Brenda J. King  
Ms. Helene W. King, Ph.D.  
Ms. Lauren Kingsland  
Mr. Morris Klein, Esq  
Ms. Lois Knaus  
Ms. Kathleen Knepper  
Ms. Ruth E. Koczela  
Ms. Elizabeth Koniuszkow &  
Mr. Michael Wexler  
The Korfs  
Ms. Christy Kramer  
Ms. Despina M. Kuester  
Mr. Bradley Lake  
Mr. Michael M. Landa

Landman Family Charitable Foundation  
Mrs. Alden S. Lattu & Mr. Gordon Lattu  
Ms. Kris B. Laurenti  
Dr. William R. Leahy &  
Ms. Christine M. Leahy  
Ms. Amy Le Sueur  
Mr. Irwin Lebow & Mrs. Grace H. Lebow  
Mr. & Mrs. Morton A. Lebow  
Mr. & Mrs. Arnold H. Leibowitz  
Ms. Amanda C. Leiter &  
Mr. Sambhav Sankar  
Ms. Jane Evins Leonard  
Mr. Adam Levner  
Ms. Judith Levy & Dr. George M. Ruby  
Ms. Shoshana Lew  
Ms. Joann Lewinsohn  
Dr. Carole Lewis  
Dr. G. Douglass Lewis &  
Mrs. Shirley Lewis  
Mrs. Susan B. Lieberman  
Ms. Nancy E. Lindsay  
Mr. & Mrs. Earl W. Lindveit  
Ms. Arielle Linsky  
Mr. Alain R. Locussol  
Mrs. Susan Lohsen  
Ms. Carolyn Long  
Mrs. Elizabeth Lowenstein  
Mrs. Susan R. Lutz  
Mrs. Allen MacDonald  
Ms. Susan MacKnight  
Mr. Kirk Manhardt  
Mr. Philippe Marciniak  
Mrs. Ingrid Margrave  
Mr. Eliot Marshall  
Mr. David C. Martin  
Ms. Barbara Marzetta  
Mrs. Allene R. Masters  
Mrs. Joan Maxwell & Mr. David O. Maxwell  
Mrs. Vera Waltman Mayer &  
Mr. Arnold Mayer  
Ms. Heidi Mayor  
Mr. James McBride  
Ms. Alicia McCarthy  
Ms. Camilla McCaslin  
Mr. & Mrs. William J. McCloskey  
Ms. Kathryn McCreight  
Ms. Edna H. McCrindle  
Mrs. Maria F. McCulloch  
Ms. Mary McGrath  
Ms. Sarah W. McMeans  
Mr. Jerry D. McPike  
Dr. & Mrs. Sander H. Mendelson  
Mrs. Starke P. Meyer  
Mr. Damon C. Miller  
Judge Gregory E. Mize &  
Ms. Marisa Mize  
Mrs. Char Mollison  
Ms. Kathryn A. Morisse  
Mr. Wendell R. Morris &  
Mrs. Brenda C. Morris  
Mrs. Barbara P. Morrison  
Ms. Robin Mosle  
Mr. & Mrs. Robert J. Mulligan  
Mr. Edward J. Murphy  
Ms. Mary J. Nagelhout  
Ms. Waldy Naimie  
Ms. Valerie Nannery

Mr. John E. Napolitano  
Mr. James P. Nash  
The Honorable James E. Nathanson &  
Mrs. Minna Nathanson  
Mr. Morton Needelman  
Ms. Hollis B. Nesbit  
Mr. Thomas Nessinger  
Ms. Betty Nevins  
Ms. Elizabeth B. Niederman  
Ms. Nancy W. Nollen  
Ms. Julia J. Norrell  
Mr. & Mrs. Ronald L. North  
Ms. Janet Nunn  
Ms. Lenore Oblitas  
Mr. & Mrs. William R. O'Brien  
Ms. Sharon O'Connor  
Ms. Jane S. O'Grady  
Mr. William L. O'Hare &  
Mrs. Patricia A. O'Hare  
Mr. & Mrs. W. Thomas Oliver  
Ms. Joanne Omang  
Ms. Lisa Orange  
Mr. & Mrs. David M. Osnos  
Ms. Mary Paradise  
Ms. Katherine H. Parmalee  
Mr. Robert Paxton  
Ms. Lorine K. Pergament  
Ms. Eve Persian  
Mrs. Jane Pettit & Dr. Robert Henkin  
Mr. Justin Pickens & Ms. Carol Sardinha  
Ms. Nancy Piness  
Dr. Susan Plaeger  
Playwrights Forum  
Mrs. Pauline D. Powell  
Ms. Alice L. Powers  
Mr. William S. Puppa  
Ms. Julia Quinn  
Ms. Chhaya Rao  
Mrs. Rosemary S. Reid  
Mr. Lawrence D. Rickards  
Mr. Jonathan Rifkin  
Ms. Alicia Ritchie  
Mr. William Roach & Ms. Susan Roach  
Ms. Sara Robinson & Mr. Gerald Robinson  
Dr. Alexandra M. Roceric  
Ms. Mary Rojas  
Ms. Nancy D. Rosan  
Mr. Ira Albert Russell  
Mrs. Juliet A. Sablosky  
Ms. Edith Safuta  
Mrs. Hortensia Saginor  
Mr. Lawrence F. Salmen &  
Ms. Caroline Mascarell  
Ms. Gladys G. Saunders  
Ms. Teresa Savarino &  
Mr. Omar S. Hopkins  
Mr. Lester Scall & Ms. Joyce Scall  
Mr. William G. Schaefer  
Mr. John V. Schappi  
Mrs. Barbara Scherer  
Ms. Lois J. Schiffer  
Ms. Susan Schneider  
Ms. Virginia Schofield  
Ms. Elisabeth P. Schouten  
Dr. Molly Schuchat  
Mrs. Diane Schumacher  
Mrs. Karen K. Schwartz, Esq.

## THANK YOU TO OUR VOLUNTEERS!

You provide thousands of hours—delivering meals, visiting homebound older adults, supporting Iona's activities—and are absolutely essential to Iona's mission and work.

Ms. Joan H. Searby  
 Dr. Sal S. Selvaggio &  
 Mrs. Andrea Selvaggio  
 Mr. Simon H. Serfaty & Mrs. Gail F. Serfaty  
 Ms. Marnie Shaul  
 Mr. & Mrs. David E. Shumaker  
 Ms. Arlene Sidell  
 Ms. Fanchon Silberstein  
 Dr. Margo Silberstein  
 The Honorable Ints Siliis  
 Ms. Patricia E. Simpich  
 Ms. Julie Simpson  
 Ms. Shelley Singer & Mr. Michael Gross  
 Mr. Dennis Siracusa  
 Ms. Katie Smith Sloan &  
 Mr. Richard S. Sloan  
 Ms. Ann G. Sloane  
 Dr. Mary S. Slusser  
 Ms. Edna R. Small  
 Ms. Carla S. Smith & Mr. Bill Smith  
 Mr. Arthur & Mrs. Earlene Smith  
 Ms. Helen H. Smith  
 Mr. Randolph Smith  
 Mr. Eugene Sofer & Ms. Judith Bartnoff  
 Mr. John P. Sontag & Mrs. Sheila Sontag  
 Ms. Susan K. G. Spaulding  
 Mr. Sidney D. Spencer  
 Mr. James Springer & Mrs. Carol Springer  
 Ms. Kathleen M. Stack  
 Mrs. Jean A. Starks  
 Mr. Daniel Stevenel  
 Ms. Barbara R. Stevens & The Honorable  
 Rufus G. King III  
 Mr. Michael L. Stevens  
 Ms. Alice F. Stewart & Mr. Bill Wilcox  
 Ms. Elizabeth K. Stewart  
 Ms. Doris A. Stilwell  
 Mr. Alan D. Strasser & Ms. Patricia Hartge  
 Ms. Helen Marie Streich  
 Ms. Cheryl Stultz  
 Mrs. Judith Sugarman &  
 Mr. Richard L. Sugarman  
 Ms. Janet Sumner  
 Mrs. Anne Tager & Mr. Evan M. Tager  
 Ms. Donna Tanner  
 Mr. & Mrs. John K. Tanner  
 Dr. Terese R. Tansey  
 Temple Sinai  
 The Honorable Mary Terrell  
 Ms. Leah K. Thayer & Ms. Marina Colby  
 Miss Celeste Thompson  
 Mrs. Betty R. Tilley  
 Mr. Willard Tom &  
 Ms. Natalie Lichtenstein  
 Ms. Lalie Tongour & Mr. Michael Tongour  
 Ms. Lillie E. Torbert  
 Ms. Barbara Boyle Torrey  
 Mrs. Judith A. Towle  
 Tranquil Space  
 Ms. Margaret Treadwell  
 Mrs. Elena Tscherny  
 Ms. Diane Tuckman  
 Ms. Nancy R. Turnbull  
 Ms. Barbara Turnham  
 Mrs. Katharine Tyler  
 Mr. Richard Ugelow & Mrs. Susan Ugelow  
 Dr. Sanford J. Ungar & Dr. Beth Ungar  
 United Way of The Greater Triangle  
 Ms. Barbara A. Upton  
 Mrs. Joan Van DeMoortel &  
 Mr. Victor Van DeMoortel  
 Ms. Elaine Vaudreuil  
 Dr. Alkinoos Vourlekis &  
 Dr. Betsy S. Vourlekis  
 Ms. Claudina Y. Wallace  
 Ms. Megan M. Wallace  
 Ms. Marilyn Wandrus

Ms. Susan Washington  
 Ms. Betsy L. Weingarten  
 Mrs. Anne West & Mr. Bill West  
 Mr. George West  
 Ms. Robin L. White  
 Ms. Louise Wides  
 Ms. Cynthia M. Wilcox  
 Mr. Howard P. Willens &  
 Ms. Deanne C. Siemer  
 Ms. Alison Williams  
 Ms. Ann E. Williams  
 Mr. Dennis P. Williams  
 Mr. James C. Williams &  
 Ms. Elizabeth Williams  
 Ms. Patricia Williams  
 Mr. Robert Williams & Mrs. Ruth Williams  
 Mrs. Mary Jane Wilson Bilik  
 Mr. Timothy Withers &  
 Mrs. Catherine Withers  
 Mrs. Barbara Wolanin & Mr. Phil Brown  
 Mr. Lewis W. Wolfson  
 Ms. Ellen Wormser  
 Ms. Mimi Y. Yeh  
 Ms. Karen S. Yingst  
 Ms. Johanna Yogodzinski  
 Ms. Mary C. Young  
 Mr. W. Randolph Young  
 Mr. William G. Young  
 Mrs. Carol S. Zavis  
 Ms. Marlyn L. Zelkowitz  
 Mrs. Rita Zener  
 Mrs. Margot L. Zimmerman  
 Ms. Deborah Zuckerman

**UNDER \$100**

Ms. Susan Absher & Mr. Robert Hohl  
 Ms. vEnesa Y. Acham  
 Mr. Nicholas A. Addams  
 Mr. & Mrs. Harry Aid  
 Ms. Ellen Alers  
 Ms. Nancy Allchin & Mr.  
 Richard Allchin  
 Mr. Reuben Altman  
 Ms. Lynn Andretta  
 Ms. Penelope Andrews  
 Anonymous (9)  
 Ms. Nancy Arbutnot  
 Mr. David F. Arnold &  
 Mrs. Courtney Arnold  
 Mrs. Josephine C. Baker  
 Mr. & Mrs. David J. Bardin  
 Ms. Sarah B. Barnett  
 Mr. & Mrs. Thomas A.  
 Bauder  
 Mr. Walter L. Baumann &  
 Mrs. Andrea Baumann  
 Ms. Kathleen Beal  
 Mr. George T. Beall  
 Ms. Phyllis Beek  
 Ms. Stacey Berk  
 Mrs. Barbara A. Berman  
 Ms. Eileen C. Berman  
 Dr. & Mrs. Philip Berman  
 Ms. Beth Bienvenu  
 Ms. Mary Beth Bloomberg  
 Ms. Bonnie Bobbitt  
 Ms. Holly A. Bode  
 Mr. Charles Boone  
 Mr. Sidney E. Booth &  
 Mrs. Elka R. Booth  
 Ms. Monica Borkowski  
 Mr. John Borrazzo &  
 Ms. Carol Piwowarski  
 Ms. Shelby Bowser  
 Ms. Katherine B. Brebbia  
 Ms. Peggy R. Breda  
 Ms. Sylvia Broome

Rev. Arlester Brown &  
 Mrs. Ozeal S. Brown  
 Mrs. Deborah M. Bruskin  
 Dr. William L. Bryan  
 Ms. Ellen W. Buchanan  
 Mr. Dixon Butler & Mrs. Susan Butler  
 Mr. & Mrs. James D. Butts  
 Dr. Eve M. Byford Peterson  
 Ms. Betty M. Byrne  
 Dr. Edgar Cahn  
 Ms. Margaret Camp  
 Ms. Julia P. Cancio  
 Careoesel  
 Mr. Michael Buzzard  
 Ms. Mary Castiblanco  
 Mr. Tyrone Cave  
 Ms. Adele Cerrelli  
 Mr. & Mrs. Robert L. Chamberlain  
 Ms. Liza Chapkovsky  
 Mr. Irwin M. Chapman &  
 Mrs. Arlene S. Chapman  
 Dr. Laura Tosi & Dr. David S. Chu  
 Ms. Ghislaine Clarke  
 Mr. & Mrs. Wyndham Clarke  
 Mr. William Clarkson, V  
 Mr. & Mrs. Lyman B. Coddington  
 Mr. L. Dayton Coe II & Mrs. Joanne Coe  
 Mrs. Carol C. Coffin  
 Mr. Stanley M. Cohen  
 Ms. Lee Collinge  
 Ms. Vera I. Connolly  
 Mrs. Susan B. Coover &  
 Mr. Edwin R. Coover  
 Ms. Megan Corey  
 Mrs. Jose T. Croll  
 Ms. Jill Cummings  
 Ms. Lydia Curtis  
 Mr. Mark Dann

Ms. Romana Danysh  
 Ms. Shirley de la Barre  
 Ms. Bonifacia V. dela Rosa  
 Mrs. Evelyn Devlin  
 Ms. Harriet Dichter  
 Ms. Rosemary Dickerson  
 Mr. Judson Dolphin  
 Ms. Janel E. Doughten  
 Ms. Judith Y. Downey  
 Ms. Susan M. Drobis  
 Ms. Patricia A. Dubroof  
 Ms. Julie Dunne  
 Ms. Nadine Dutcher  
 Ms. Rosanne Eitzen  
 Ms. Patricia Elder  
 Mr. David Elfin  
 Ms. Eleanore J. Elser  
 Ms. Susan Erim  
 Mr. Richard J. Evans  
 Ms. Angella Farserotu  
 Mr. Joshua Feinberg  
 Ms. Rhonda C. Fields  
 Ms. Elizabeth Ann Fisher  
 Ms. Patricia B. Fisher  
 Ms. Katie Fitzgerald  
 Ms. Mary Sue Flanagan  
 Ms. Barbara M. Fletcher  
 Ms. Helen Fogel  
 Mr. Robert Fogel & Mrs. Betti G. Fogel  
 Ms. Frances E. Francis &  
 Mr. Robert C. McDiarmid  
 Ms. Janet L. Friedline  
 Ms. Bonnie Friedman  
 Ms. Susan Friedman  
 Mr. Mitchell Gail  
 Mr. John W. Garten &  
 Ms. Susana M. Garten  
 Ms. Kathleen T. Garvey

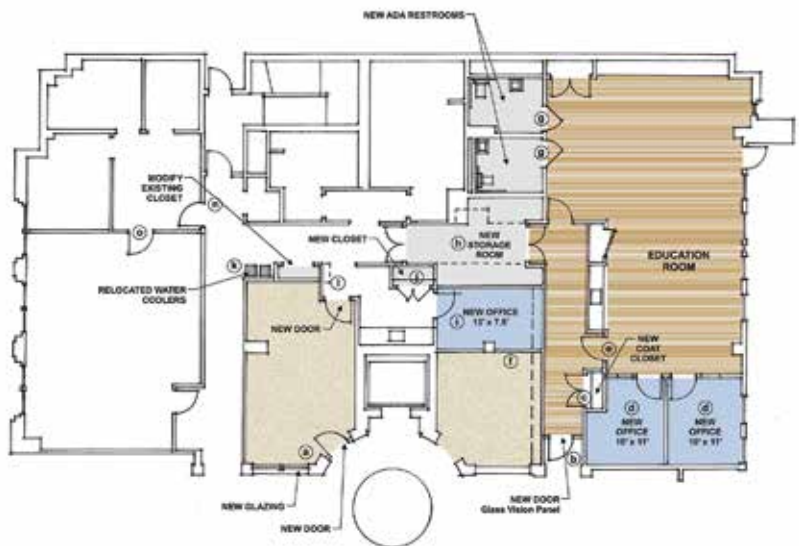

After a summer of renovations, Iona unveiled new space for our Wellness & Arts Center's robust day programming. This expansion will allow us to serve 20 more participants with chronic conditions and their family caregivers each week.



We had the tremendous honor of welcoming South Korean First Lady Kim Jung-sook to our Wellness & Arts Center. During her visit, the First Lady learned about our enriching day program and joined participants in an art therapy session. President Moon Jae-in and the First Lady have both expressed their commitment to funding services for older adults with dementia and their families in South Korea. It was an honor to be “ambassadors” for our special program and Washington, DC.

Mr. Henry P. Gassner &  
Ms. Betty Chia Karro  
Ms. Adrienne George  
Ms. Augusta T. Getchell  
Mr. John P. Giacomini &  
Mrs. Ma Victoria Giacomini  
Mr. Dennis Gilbert & Ms. Nina M. Serafino  
Ms. Elise Gillette  
Ms. Nina Glasner  
Mr. Morton M. Gluck  
Mr. Charles D. Goldman &  
Ms. Deanna Okrent  
Mr. Mitchell A. Goldstein &  
Ms. Susan Schiffer  
Ms. Lynn Golub Rofrano  
Ms. Joan C. Goodrich  
Ms. Rebecca Gorin  
Ms. Karen J. Graves  
Mrs. Nancy M. Gray  
Mr. Matthew Green  
Ms. Megan Griffith  
Mr. Robert D. Grigg, III  
Mr. David Hall  
Ms. Vicky Hall  
Ms. Elisabeth Hanley Cremers  
Mrs. Karen Hansen Turton  
Ms. Patti Harburger  
Mrs. Theresa Hare  
Ms. Edith Harriet  
Mr. & Mrs. Andrew Harris, Jr.  
Mr. John E. Harrison, III  
Ms. Daphne A. Hawkins  
Mrs. Mary Jane Hayden

Mr. Lawrence Hayes  
Mr. John A. Hays & Ms. Sharon Hays  
Ms. Linda S. Heaney  
Ms. Rachel R. Hecht  
Mrs. Floyd F. Hedlund  
Mr. Werner Hein &  
Mrs. Marleen Hein Dunne  
Mrs. Julie K. Herr & Mr. Donald Herr  
Ms. Barbara Herzog  
Mr. Jerome A. Hochberg  
Ms. Marilyn G. Hopkins  
Ms. Patricia H. Horan  
Mrs. Sandra Horowitz  
Mr. Anthony Hyatt  
Ms. Melinda Hyman  
Mrs. Evelyn Idelson  
Ms. Barbara J. Ioanes  
Ms. Virginia E. Jackhellm  
Ms. Joan H. Jackson  
Mr. Randolph Janney & Mrs. Anne Janney  
Mr. Myles Johnson & Mrs. Ruth Johnson  
Ms. Charlotte Jones  
Ms. Karla L. Jones  
Ms. Mary A. Kalmanson  
Ms. Marcia Kass  
Ms. Lynn Kauffman &  
Mr. Nicholas Kauffman  
Ms. Audrey Kellison  
Ms. Sarah M. Kellogg  
Ms. Jean Kepler  
Mr. Leland Kiang  
Mr. G. Joseph King  
Mrs. Loretta B. Kiron

Ms. Kay Klayman  
Mr. Philip B. Kline & Mrs. Mabel E. Kline  
Ms. Courtney Knauth  
Ms. Carol Knouse  
Mr. Christopher Kojm & Ms. Ann Misback  
Mr. Michael Kolakowski  
Ms. Nancy C. Korman &  
Mr. Everett Korman  
Mr. Peter D. Koutsandreas  
Mr. David G. Kraft  
Mrs. Sally Kranz & Dr. Marvin W. Kranz  
Ms. June B. Kress  
Mrs. Sali Ann Kriegsman  
Ms. Elizabeth Kriskie  
Mr. & Mrs. Neal E. Krucoff  
Ms. Florence Kuipers  
Ms. Barbara S. Labier  
Mr. Eugene I. Lambert &  
Mrs. Janet V. Lambert  
Mr. Roger Lang & Mrs. Joann Lang  
Ms. Helma F. Lanyi  
Ms. Erika M. Latchis, M.D.  
Ms. Anna M. Lawton  
Mrs. Louise F. Lazare  
Ms. Elizabeth Leader  
Ms. Suzanne Legault  
Ms. Cynthia P. Lehmann  
Mr. James Lemert  
Ms. Mary E. Leshner  
Mr. John D. Loikow & Mrs. Ann H. Loikow  
Mr. Howard London & Ms. Sharan London  
Mr. Alejandro Lopez Mejia  
Ms. Anne L. MacArthur

Ms. Gail MacColl  
Ms. Debra Malovany  
Ms. Jean E. Mammen  
Dr. E. Gordon Margolin  
Mr. & Mrs. David H. Marlin  
Mrs. Abby Martin  
Mr. Sheldon Martin  
Mrs. Abelle Mason & Mr. Robert S. Mason  
Mr. Larry R. Matlack &  
Mrs. Linda S. Matlack  
Ms. Nancy N. McCabe  
Ms. Caroline Howard McCleskey  
Mrs. Dominga McFadden  
Ms. Jenean McKay  
Ms. Martha T. Mednick  
Mr. & Mrs. Harry Melamed  
Ms. Beatrice E. Menge  
Mrs. James G. Mersereau  
Mrs. Anne Messina  
Mrs. Beatrice B. Meyerson  
Mr. Charles Miller & Mrs. Jeanette Miller  
Ms. Ellie Miller  
Ms. MaryAnn Miller  
Mr. Oral Miller  
Ms. Christina Miner  
Ms. Jean P. Moore  
Ms. Maureen Moore  
Ms. Mary Margaret Morse  
Mr. Robert Muhawieh &  
Mrs. Luna Muhawieh  
Mr. Allen L. Myers  
Dr. Aruna Natarajan  
Ms. Paulette Nehama  
Mr. Bryce Nicholls  
Ms. Nona Lee Nicholson  
Mr. F. Jefferson J. Nowak  
Ms. Charlotte Nusberg  
Ms. Christine Oblitas  
Ms. Katharine L. Oliver  
Ms. Geraldine E. Ostrove  
Ms. Jo Ousterhout  
Ms. Ashley Paik & Mr. Eric Suh  
Ms. Mary Elizabeth Pate  
Ms. Ethel S. Peal  
Mr. Fred H. Pelzman  
Ms. Elisabeth M. Pendleton  
Mr. Louis R. Perkins  
Ms. Sieglinde Peterson  
Ms. Annie Petsonk  
Mr. David E. Pinsky &  
Mrs. Marjorie R. Pinsky  
Ms. Ruth Polan  
Mr. Santo Pontiere  
Ms. Glendora Price  
Mr. Malcolm L. Pritzker &  
Mrs. Sandra G. Pritzker  
Ms. Kathleen Quilter  
Mr. Louis Rabil  
Mr. Tod A. Ragsdale &  
Mrs. Carol Ragsdale  
Mrs. Maria E. Ramirez  
Ms. Barbara Ratner  
Mr. Mark A. Kachor & Ms. Gail Rebhan  
Mr. Deno Reed &  
Mrs. Monica Palenski Reed  
Ms. M. Arlette Remy  
Mrs. Francesca C. Rey  
Ms. Joyce Rice Saunders  
Mrs. Anne Werner Richardson  
Ms. Janet H. Ridgely  
Mr. Albert Ritzenberg  
Ms. Maria A. Rivas  
Mr. Harry J. Robinson &  
Mrs. Ruth P. Robinson  
Ms. Joan Rosenstein  
Mrs. Lenora Rowell  
Mr. & Mrs. Richard B. Ruge

Thanks to the action and advocacy of Iona and dedicated community members, we secured essential funding from the DC Office on Aging to continue a federal Alzheimer's grant. This grant supports citywide programming for people with memory loss who are living alone and provides respite and other support to family care partners. More than 500 individuals and families benefit from these critical programs.

Ms. Antoinette S. Russin  
 Ms. Lucille B. Said  
 Ms. Emma Sajsa  
 Ms. Alisha J. Sanders  
 Mrs. Marilyn B. Schachter  
 Ms. Susan Schiffer  
 Mr. William John Schofield  
 Ms. B. J. Seebol  
 Ms. Ruth Shari  
 Mr. John Sheahan &  
 Ms. Mary Lee Giblon Sheahan  
 Ms. Alice Sheen  
 Ms. Claire Sherman  
 Ms. Lisa Sherman  
 Ms. Joan Sigel  
 Mrs. Elsa P. Skaggs & Mr. Glenn E. Skaggs  
 Ms. Gertrude L. Slifkin  
 Mr. & Mrs. Francis G. Smith  
 Ms. Judith Snyder  
 Ms. Rose Helene H. Spreiregen &  
 Mr. Paul D. Spreiregen  
 Ms. Pamela Stanard  
 Ms. Anna M. Staub  
 Ms. Barbara Steck  
 Mrs. Robert L. Steiner  
 Mr. Theodore Stewart  
 Mr. Gerard Stocker  
 Dr. Philippa Strum  
 Mrs. Jill Tanenbaum &  
 Mr. Alan Tanenbaum  
 Dr. Claudia Taubman  
 Ms. Cleonice Tavani  
 Mr. Timothy R. Tehan  
 Ms. Helen Templin  
 Ms. Sonia Tergas  
 Ms. Evelyn Thomas  
 Ms. Ann Todd  
 Ms. Courtney Tolbert &  
 Mr. Russell Smith  
 Ms. Kit Turen  
 Mr. & Mrs. Donald H. Turnbull  
 Ms. Nelly M. Urbach  
 Mr. Stephen L. Urbanczyk &  
 Mrs. Judith A. Urbanczyk  
 Colonel Richard Vande Hei &  
 Dr. Elaine Vande Hei  
 Ms. Lucinda Vavoudis  
 Mr. John Vera  
 Mr. Steven Walden  
 Ms. Jane C. Waldmann  
 Ms. Alayna Waldrum  
 Mr. Joseph M. Walker

Mr. Stanley Wanger  
 Mr. & Mrs. Donald S. Wasserman  
 Mrs. Elinor Waters  
 Mr. Robert P. Watkins, III &  
 Mrs. Ann M. Watkins  
 Mr. George E. Watson &  
 Mrs. Louisa C. Watson  
 Ms. Valerie Watson  
 Ms. Joan O. Weiss  
 Mrs. Anne D. Whalen  
 Mr. Robert E. Wiczorowski  
 Ms. Caren A. Wilcox  
 Mrs. Claude L. Williams van Bellinghen  
 Mr. David Wise, III  
 Ms. Sara H. Yanes  
 Mrs. D. Beth Yingling &  
 Mr. Charles T. Edwards, III  
 Ms. Roberta Youmans  
 Mr. Theodore Zahn & Mrs. Ann E. Zahn  
 Ms. Juanita Zientara  
 Ms. Deborah Zients

**TRIBUTE GIFTS**

*In honor of Alice Abramson*  
 Mr. Joshua Feinberg  
 Ms. Nina Glasner  
*In honor of Parivash "Pari" Amirshahi*  
 Ms. Joan H. Searby  
*In honor of Bill Amt*  
 Ms. Joan Rosenstein  
*In memory of Elly Andonyadis*  
 The Korfs  
 Miss Celeste Thompson  
*In honor of Rosie Aquila*  
 Ms. Rebecca Gorin  
*In memory of Ormand Austin*  
 Mr. David Austin  
 Mr. Jon Austin  
*In honor of Jeannine Summerly Balog*  
 Ms. Kathy Balog  
*In honor of Rob Bamberger*  
 Ms. Jacqueline Corbett  
*In honor of Sharon Bauer*  
 Anonymous  
*In memory of Eva Berenson*  
 Mrs. Barbara A. Berman  
*In honor of Albert Bilik*  
 Mrs. Mary Jane Wilson-Bilik  
*In memory of Harvey Block*  
 Ms. Margaret Almazan  
 Ms. Patricia Chick  
 Ms. Helen H. Smith

*In honor of Wendy Feldman Block*  
 Mr. & Mrs. David E Feldman  
 Ms. Nancy Korman &  
 Mr. Everett Korman  
*In honor of Deborah M. Blum*  
 Ms. Fiona Druy  
 Mrs. Frances E. Forman  
 Ms. Judith E. Goldstein  
 Ms. Diane Greenspun  
 Mrs. Carol Kaplun & Mr. Paul T. Kaplun  
 Mr. Morton Needelman  
 Ms. Julia Quinn  
 Mr. Randolph Smith  
 Ms. Donna Tanner  
 Mrs. Mary Jane Wilson-Bilik  
*In honor of Oscar Boitel*  
 Ms. Ana Maria Boitel  
*In honor of Polly McRee Brown*  
 Ms. Jo Ousterhout  
*In memory of Joyce Carter*  
 Ms. Pamela C. Cooper &  
 Mr. David M. Cooper  
*In honor of Liza Chapkovsky*  
 Ms. Beatrice E. Menge  
 Dr. Alexandra M. Roceric  
*In honor of Sandy Christenberry*  
 Ms. Alice L. Powers  
*In memory of William Christenberry*  
 Ms. Shelley Singer & Mr. Michael Gross  
 Ms. Mary A. Kalmanson  
 Ms. Sally Kaplan & Ms. Julie Kaplan  
 Ms. Julia J. Norrell  
 Ms. Lenore Oblitas  
 Ms. Alice L. Powers  
*In memory of Carol Cohen*  
 Mrs. Louise F. Lazare  
*In memory of Janet R. Colabella*  
 Ms. Pamela C. Cooper &  
 Mr. David M. Cooper  
 Ms. Ruth Shari  
 Mr. Timothy Withers &  
 Mrs. Catherine Withers  
*In honor of Megan Collier*  
 Ms. Beatrice E. Menge  
*In memory of Ro Collis-Wolf*  
 Mr. Mark Dann  
*In honor of Jackie Conn*  
 Ms. MaryAnn Griffin  
*In honor of Karen Corey*  
 Ms. Megan Corey  
*In memory of Richard Cys*  
 Ms. Pamela C. Cooper &  
 Mr. David M. Cooper  
*In memory of Shirley P. Dalrymple*  
 Ms. Pamela C. Cooper &  
 Mr. David M. Cooper  
*In memory of Jesse O. Dejanos*  
 Mr. Daniel Stevenel  
*In memory of Ken Doggett*  
 Ms. Rosalyn P. Doggett  
*In memory of Roberta Douglas*  
 Mrs. Jean A. Starks  
*In honor of Jason Dring*  
 Ms. Mary Elizabeth Pate  
*In memory of Michael Drucker*  
 Ms. Pamela C. Cooper &  
 Mr. David M. Cooper  
*In honor of Margery Elfin*  
 Mr. David Elfin  
*In honor of James D. Finkelstein*  
 Dr. Barbara Finkelstein  
*In honor of Zandra Flemister*  
 Ms. Jo Collinge  
*In honor of Zandra Flemister & John Collinge*  
 Ms. Lee Collinge  
 Ms. Jo Collinge

*In honor of Elizabeth Fox*  
 Mrs. Betty Guyot & Mr. Henry L. Guyot  
*In memory of Margaret Fox*  
 Mr. Jim Fox  
*In honor of Tara Frank*  
 Ms. Yiu-Fong Dew  
*In memory of Patricia S. Froelicher*  
 Ms. Harriet Dichter  
 Mrs. Theresa Hare  
*In honor of Ann Fudjak*  
 Mr. David Wise III  
*In honor of Trevor Goodyear*  
 Mr. Robert Williams &  
 Mrs. Ruth Williams  
*In memory of Margo Kranz Gottesman*  
 Mrs. Sally Kranz & Dr. Marvin W. Kranz  
*In memory of Ted Grofer*  
 Ms. Pamela C. Cooper &  
 Mr. David M. Cooper  
*In memory of James L. Hanley*  
 Ms. Elisabeth Hanley-Cremers  
*In memory of Marion J. Helms*  
 Mr. Robert Evans  
*In memory of Peggy Hilleary*  
 Mr. Randolph Janney &  
 Mrs. Anne Janney  
*In memory of Robert Horowitz*  
 Mrs. Sandra Horowitz  
*In memory of Eva Ingram*  
 Mrs. Mary T. Bartlett  
*In memory of Eve R. Jaffe*  
 Ms. Rochelle H. Jaffe  
*In memory of Lorna Johnson's parents*  
 Ms. Lorna E. Johnson  
*In memory of Frank Jones*  
 Ms. Pamela C. Cooper &  
 Mr. David M. Cooper  
*In honor of Jean & Pete Johnson*  
 Ms. Kay E. Rogers  
*In honor of Carol Kaplun*  
 Anonymous  
 Mr. Morton Needelman  
*In honor of Carol & Paul Kaplun*  
 Ms. Diane Greenspun  
*In honor of Leland Kiang*  
 Ms. Sandra Rottmann  
*In honor of Sam Kilpatrick*  
 Mr. Dixon Butler & Mrs. Susan Butler  
 Mr. Howard London &  
 Ms. Sharan London  
*In honor of Anna Peltin Lake*  
 Mr. Bradley Lake  
*In honor of Ruth & Otto Landman*  
 Landman Family Charitable  
 Foundation  
*In memory of Diann Lawry*  
 Mrs. Jane Pettit & Dr. Robert Henkin  
*In honor of Elizabeth O'Hara Lazo*  
 Mr. & Mrs. William R. O'Brien  
*In honor of Grace Lebow*  
 Dr. Rhoda Baruch  
 Ms. Paulette Nehama  
 Ms. Nona Lee Nicholson  
 Ms. Joan O. Weiss  
*In memory of Beatrice Lindsten*  
 Ms. Pamela C. Cooper &  
 Mr. David M. Cooper  
*In memory of John Lowe*  
 Ms. Pamela C. Cooper &  
 Mr. David M. Cooper  
*In memory of Bernice Malovany*  
 Ms. Debra Malovany  
*In memory of Norene Martin*  
 Mr. David C. Martin  
*In honor of Danielle Mazur*  
 Ms. Yiu-Fong Dew

*In honor of Mary Lou McGee*  
Mrs. Elsa P. Skaggs &  
Mr. Glenn E. Skaggs

*In memory of Robert Bensen Meyer, Jr.*  
Mrs. Maria Teresa Meyer

*In honor of Ruth Nadel*  
Ms. Barbara Ratner

*In honor of Maegan Olivos*  
Mr. & Mrs. William Delaney

*In memory of Robert & Noel Plummer*  
Mr. Thomas Nessinger

*In honor of Jack Rachlin*  
Ms. Nancy Allchin & Mr. Richard Allchin

*In memory of Mary White Reilly*  
Mr. Todd Glassman

*In honor of Fred Reiner & Susan Liss*  
Ms. Eleanor Acheson &  
Ms. Emily Clark Hewitt  
Mr. Lincoln W. Caplan &  
Ms. Susan Carney

*In honor of Lisa Rindner*  
Mr. Robert Paxton  
Mr. Yosef Riemer & Ms. Vitina Biondo  
Ms. Joan Rosenstein

*In honor of Deb Rubenstein*  
Ms. Barbara B. Franklin

*In memory of Sharon S. Schaefer*  
Ms. Marnie Shaul

*In honor of Ann Marshall Schweitzer*  
Mr. Geoffrey F. Aronow &  
Ms. Melinda J. Halpert

*In honor of Judith Silberman*  
Ms. Judith Snyder

*In memory of Jackie Mae Smith*  
Ms. Lisa Orange

*In honor of Randy Smith*  
Anonymous  
Mr. Nicholas A. Addams

*In memory of Barbara Steiner*  
Ms. Jennifer C. Berrent &  
Ms. Carolyn E. Taylor

*In memory of Marjorie Stodgell*  
Anonymous  
Ms. Marilyn Wandrus

*In honor of Donna Tanner*  
Ms. Susan Washington  
Ms. Jacqueline Corbett

*In memory of Shirley Templin*  
Ms. Pamela C. Cooper &  
Mr. David M. Cooper

*In honor of Courtney Tolbert*  
Mrs. Ingrid Margrave

*In honor of John Vanderstar*  
Mr. Eugene Sofer & Ms. Judith Bartnoff

*In memory of Ann H. von Lutichau*  
Ms. Wendy Feldman Block &  
Mr. Eben Block  
Ms. Ellen W. Buchanan  
Mr. & Mrs. Preston A. Englert, Jr.  
Ms. Laura E. Stone & Mr. Ezra Levine  
Ms. Cheryl Stultz  
Mr. & Mrs. John K. Tanner

*In memory of Harry & Lillian R. Wardman*  
Helen Wardman Naselli Memorial Fund

*In memory of Anne P. Wentzel*  
Dr. Eve M. Byford-Peterson

*In honor of Sally White*  
Ms. Stacey Berk  
Mrs. Barbara Carpenter  
Ms. Pamela C. Cooper &  
Mr. David M. Cooper  
Ms. Mary E. Hileman  
Mrs. Louise C. Myers &  
Mr. Matthew L. Myers  
Ms. Nancy Piness  
Ms. Gertrude L. Slifkin

*In memory of Jane Wiegand*  
Ms. Margaret Chou Bowman  
Mr. George T. Esherick  
Mr. Timothy R. Tehan

*In memory of Alice S. Williams*  
Ms. Ann E. Williams

*In memory of André Willième*  
Ms. Camilla McCaslin

*In memory of Paget Alfred Winter*  
Ms. Lorna E. Johnson

*In memory of James G. Withers*  
Ms. Pamela C. Cooper &  
Mr. David M. Cooper

*In memory of Kimberly Young*  
Ms. Pamela C. Cooper &  
Mr. David M. Cooper

**CFC, UNITED WAY AND DC ONE FUND DONORS**

*A special thank you to ALL of our United Way and CFC Donors for 2017. Following are our 2017 donors. Please note, some remain anonymous to us, or have requested no acknowledgement.*

Ms. Suzanne Barone  
Mr. Derick W. Brinkerhoff  
Ms. Libbie Buchele  
Ms. Joan Dailey  
Mr. Robert Doubek  
Mr. Tegan M. Flynn  
Mr. Richard Heuwinkel  
Ms. Evelyn Joy  
Ms. Susan Kimmel  
Ms. Elizabeth Koprowski  
Mr. Etienne T. Lamoreaux  
Ms. Ann Mathis  
Ms. Shawn P. McLeod  
Ms. Beth McGarry  
Mr. Neil Robinson  
Mr. Eric Rosenberg  
Ms. Ann G. Sloane  
Mr. Eric Stockton  
Ms. Christine Stuppy  
Ms. Charlotte A. Whittington

**FARM-TO-TABLE DONORS**

Atwater's Bakery  
Chicano Sol  
Endless Summer Harvest  
The Farm at Sunnyside  
FRESHFARM Markets  
Giradot's Crumbs  
Licking Creek Bend Farm  
Ms. Marion Jetton  
New Morning Farm  
Patisserie Poupon  
Quaker Valley Orchards  
Spring Valley Farm and Orchard  
Twin Springs Fruit Farm  
Wollam Gardens

**IN-KIND DONORS**

Arent Fox  
Rob Bamberger, MSW  
Sharon Bauer  
Elizabeth Buchanek, LICSW  
Michael Grady, MD  
Susan Lieberman, LICSW  
Martha Ozer, MSW, LICSW  
Richard Virgil, MD  
Ely Waters

**MATCHING GIFTS**

AARP  
Dell Technologies  
GE Foundation  
International Monetary Fund  
Lincoln Financial Foundation, Inc.  
Microsoft Corporation  
The Pew Charitable Trust



**2017 Board of Directors**

**OFFICERS**

Elizabeth B. O'Hara,  
*President*  
Peter Fitzgerald,  
*Vice President*  
Sam Kilpatrick  
*Treasurer*  
Paul Manca  
*Secretary*

**MEMBERS-AT-LARGE**

Emily Allen  
Jorge Asef-Sargent  
Trevor Boothe  
Sunil Datt  
Jennifer Disharoon  
Suzanne Dutton  
Jeff Gordon  
Richard Lake  
Susan Linsky  
Shawn McLeod  
Elaine Melmed  
Rita Ross  
Tulip Shah

**2017 BOARD OF ASSOCIATES**

John A. Goodman, *Chair*  
Samuel A. Alward  
Wendy Feldman Block  
Lois H. England (*honorary*)  
Deb Englert  
Elizabeth S. Fox  
John P. Giacomini  
Mary Lou McGee  
Mary Frances McGuinness  
James Nathanson  
Joe Oppenheimer  
Susan Rodgers  
Frank Ross  
Ann Marshall Schweitzer  
Sharon L. Smith  
Richard W. Snowdon  
Armond Spikell  
Elinor Stillman  
Laura Stone  
Chapman Todd  
Debra Yogodzinski

# Make a Difference

Iona depends on your support in order to provide assistance for everyone facing the challenges of aging.

## MAKE A FINANCIAL CONTRIBUTION

Your financial support will assist Iona in providing the best programs and services to older people and their families in our community. An envelope is included in this mailing or you can donate online at [www.iona.org](http://www.iona.org) or by calling (202) 895-9401.

## MAKE A PLANNED GIFT

A donation through wills, bequests, and other charitable trusts is a tremendous way to support Iona's work. Leaving a legacy for generations to come will truly change the lives of older adults. For information, please contact the development department at (202) 895-9401 or [development@iona.org](mailto:development@iona.org).

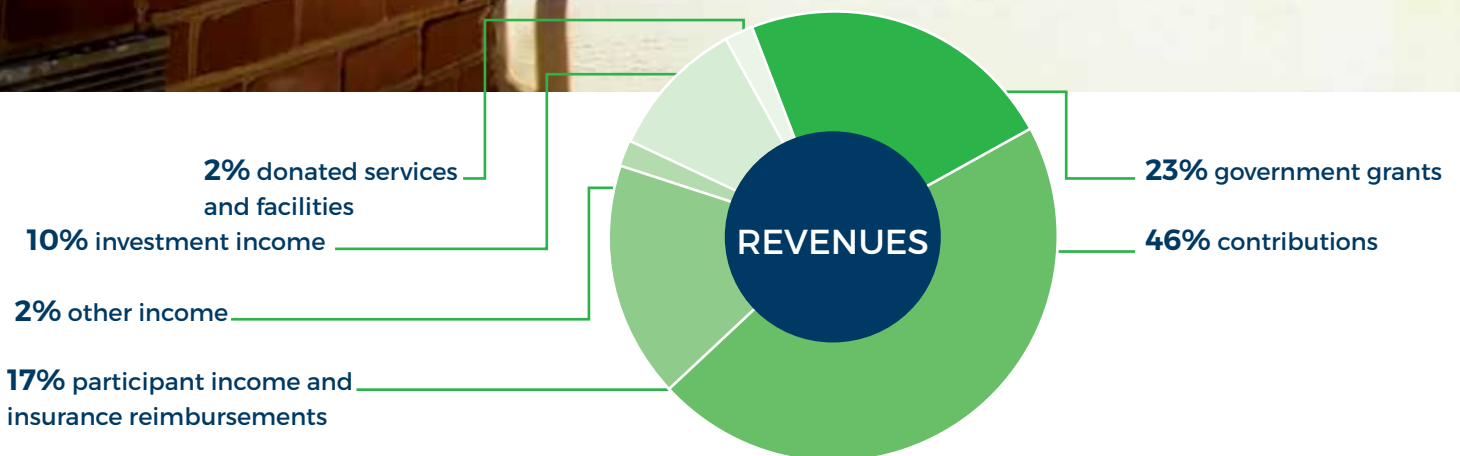

# 2017 Financials

FY October 1, 2016 – September 30, 2017  
(unaudited)

## REVENUES

Government Grants	\$1,651,681
Contributions	
Operating	\$1,510,704
Non-operating*	\$1,700,000
Participant Income and Insurance Reimbursements	\$1,168,586
Other Income	\$171,632
Investment Income	\$677,175
Donated Services and Facilities	\$150,025
<b>Total Revenue</b>	<b>\$7,029,803</b>

## EXPENSES

Administration	\$297,081
Fundraising	\$556,948
Program Services	\$3,897,418
<b>Total Expenses</b>	<b>\$4,751,447</b>

\*In 2017, Iona was grateful to receive a significant bequest of \$1 million, as well as a \$900,000 foundation gift. The Iona Board of Directors has designated \$1.7 million to our endowment in order to maintain Iona's financial stability for decades to come and the remainder to our reserve funds.

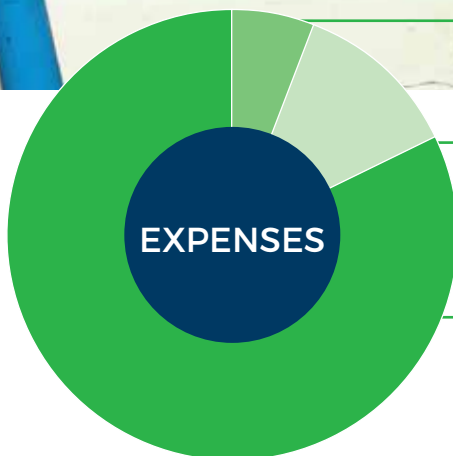

6% administration

12% fundraising

82% program services

## IONA SENIOR SERVICES

4125 Albemarle Street NW Washington, DC 20016

(202) 895-9448 | [info@iona.org](mailto:info@iona.org) | [www.iona.org](http://www.iona.org)



Iona is part of the District's Senior Service Network—Supported by the DC Office on Aging.

A photograph of a man in a red hoodie, shouting with his mouth wide open and his arms raised in the air. The background is a blurred outdoor setting with greenery.

# JOIN US!

### ADVOCATE

Join other consumers, advocates, and healthcare providers to work with the District government on long-term care issues. Contact the DC Coalition on Long Term Care, [jlevy@iona.org](mailto:jlevy@iona.org) or call (202) 895-9435. To learn more about the DC Senior Advisory Coalition, contact Sally White, [swhite@iona.org](mailto:swhite@iona.org) or call (202) 895-0246.

### VOLUNTEER

Iona was started by volunteers in 1975, and remains successful because of the efforts of our dedicated volunteers. We have volunteer opportunities for people of all ages, skills, and experience. Come to Iona to learn how you can help meet the needs of older adults in the community and keep our organization strong. Whether you are inspired by a personal interest, community service, or a group project, Iona has a place for you. Contact our volunteer coordinator at [volunteer@iona.org](mailto:volunteer@iona.org).

 [IonaSeniorServices](https://www.facebook.com/IonaSeniorServices)  
United Way #8833  
CFC #52489